

Connah's Quay Low Carbon Power

Environmental Statement Volume III Figure 8-4: Air Quality Study Area - Modelled Buildings

Planning Inspectorate Reference: EN010166

Document Reference: EN010166/APP/6.3

Planning Act 2008 (as amended)

Infrastructure Planning (Applications: Prescribed Forms and Procedure) Regulations 2009 - Regulation 5(2)(a)

Revision 00

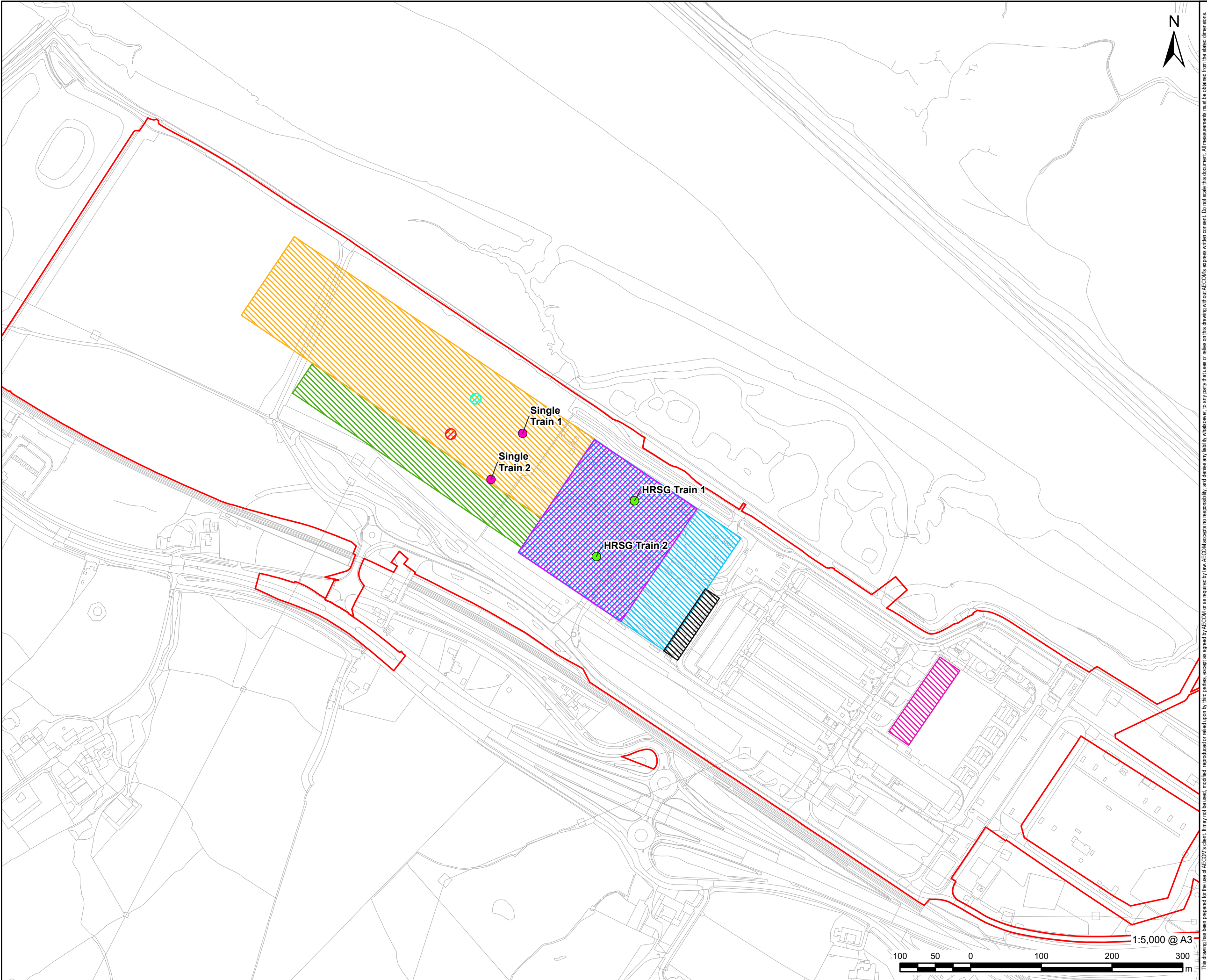

This drawing has been prepared for the use of AECOM's client. It may not be used, modified, reproduced or relied upon by third parties, except as signed by AECOM or as required by law. AECOM accepts no responsibility, and denies any liability whatsoever, to any party that uses or relies on this drawing without AECOM's express written consent. Do not scale this document. All measurements must be obtained from the stated dimensions.

- LEGEND
- Order limits

Absorber Stack

Bypass Stack

Modelled Buildings

1A

1B HRSG

1C Admin Building

1E CO2 Stripper 2

1E CO2 Stripper

1Fa

1Fb

Boiler House

NOTES

Air Quality Study Area(s), including for specific receptors shown, defined in Section 8.4 of Chapter 8: Air Quality (ES Volume II). Figure is scaled to appropriately show the buildings included in the model for the assessment, including those of the Proposed Development, rather than whole Order limits (Excluding the Accommodation Work Areas). © Crown Copyright 2025. All rights reserved. Ordnance Survey Licence AC0000808122.

ISSUE PURPOSE

Environmental Statement

DATE

July 2025

PROJECT NUMBER

60717119

FIGURE TITLE

Air Quality Study Area Modelled Buildings

FIGURE NUMBER

Figure 8-4